

Dual Port Medical Ball Valve



Features:

- 3 piece design for ease of maintenance
- Teflon seats and seals
- Valve bodies are forged C37700 alloy
- 100% hydrostatically tested
- Full port design
- 100% cleaned for medical gas use
- Individually sealed in a heavy duty plastic bag
- Blow-out proof stem
- Locking handle available
- Available sizes: 1/2” to 3”
- (2) gauge ports for ease of installation
- Desiccant pouch inside each valve bag

Specifications:

Medical shutoff valves shall be full-port, double seal with three-piece construction with the valve body being of forged bronze / brass C37700 alloy. Valves made of sand cast bodies shall not be acceptable. All material of the valves shall 100% oxygen compatible, including but not limited to: bronze / brass body, copper extensions, seats, and any sealing material used. The valves shall have Teflon seals and be designed for working pressures of 600 psi or 29” Hg vacuum with a bronze / brass body with a chrome plated brass ball and a blowout proof stem. The valves shall only require a one-quarter turn to completely open or close and shall be available in 1/2” through 3” inside diameter sizes with Type K copper tubing extensions brazed to flanges and include (2) 1/8” NPTF ports sealed with brass HEX plugs. Optional locking handles are to be available.

All medical valves shall be cleaned for oxygen service, capped at both ends, enclosed in a heavy duty plastic bag with a desiccant pouch to ensure the moisture level remains low. The bag shall include a label noting the valve is cleaned per CGA-G-4.1.

John Sterling, Inc.

“Strength through Knowledge”

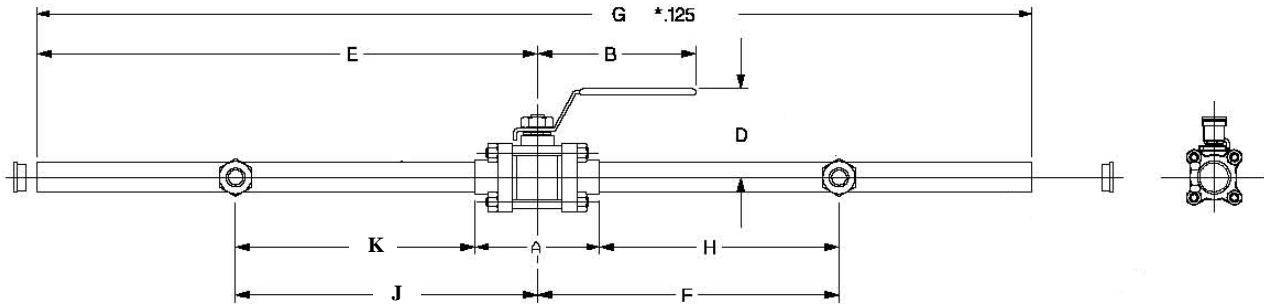

Valve Size	A	B	D	E	F	G	H	J	K	Weight (lbs)
1/2"	2.62	3.35	1.69	7.87	6.37	21	5.06	2.38	1.07	1.4
3/4"	2.93	4.33	1.89	8.25	6.06	21	4.60	2.69	1.23	2.6
1"	3.44	4.33	2.05	8.58	5.87	21	4.15	2.88	1.16	3.5
1-1/4"	3.96	5.12	2.56	8.75	5.50	21	3.52	3.25	1.27	5.2
1-1/2"	4.43	5.12	2.72	8.87	5.37	21	3.16	3.38	1.17	6.6
2"	5.55	6.30	3.15	10.87	5.00	21	2.23	3.75	0.98	12.5
*2-1/2"	6.73	9.06	4.29	16.00	4.25	32	0.89	4.25	0.89	
*3"	7.56	9.06	4.61	16.00	4.50	32	0.72	4.50	0.72	

All valve dimensions are in inches

* six bolts are used on the 2-1/2" and 3" valves